

Service Parts Instructions

PAD RETRACTION SPRING INSTALLATION INSTRUCTIONS

Hazard Alert Messages

Read and observe all hazard alert messages in this publication.

DANGER

Indicates imminent danger. Failure to follow this instruction will result in death or serious injury.

WARNING

Indicates a possibly impending danger. Failure to follow this instruction can result in death or serious injury.

CAUTION

Indicates a hazardous situation or unsafe practice which, if not avoided, could result in injury or damage to components.

How to Obtain Additional Maintenance, Service and Product Information

To access and order Meritor brake publications, visit Literature on Demand at Cummins.com.

For additional assistance, contact the Meritor OnTrac™ Customer Service Center at 866-668-7221 (US and Canada) between 7:30 AM and 10:00 PM ET Monday through Friday, and between 9:00 AM and 6:00 PM ET on Saturday; 001-800-889-1834 (Mexico); or visit our website: www.cummins.com/components/drivetrain-systems/warranty.

Positive Pad Retraction Springs

This publication provides instructions to install positive pad retraction springs on Meritor air disc brakes. Springs can be installed prior to installation of the pads, or with the pads in place on the brake caliper.

The spring design has been revised for expanded use in other caliper models. The change is backward compatible. Figure 1.

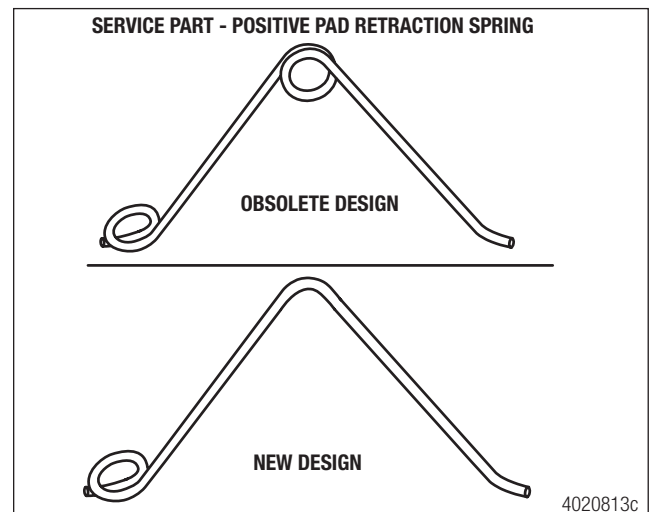

Figure 1

Safety Precautions

Before performing the procedures in this publication, read and understand the following safety precautions.

DANGER

When performing vehicle maintenance or service, always park the vehicle on a level surface and block the wheels to prevent the vehicle from moving. Failure to do so can result in death or serious personal injury.

WARNING

ASBESTOS AND NON-ASBESTOS FIBERS - Some brake linings contain asbestos fibers, a cancer and lung disease hazard. Some brake linings contain non-asbestos fibers, whose long-term effects to health are unknown. Use caution when handling both asbestos and non-asbestos materials.

WARNING

To prevent eye injury, always wear eye protection when performing vehicle maintenance or service.

INSTALLATION

1

Locate the ends of the PPR spring [A].

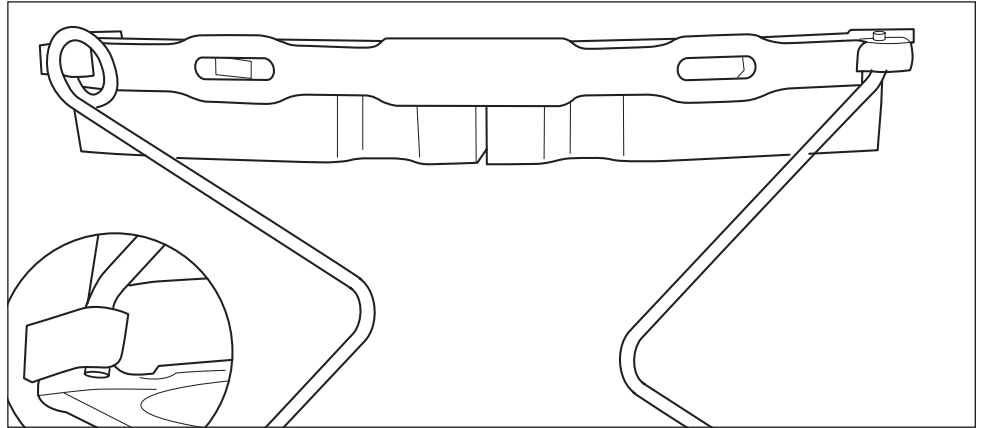

2

Set a new PPR pad on a flat surface with the friction material side facing up. Note the holes [B] in the top of the pad backing plate.

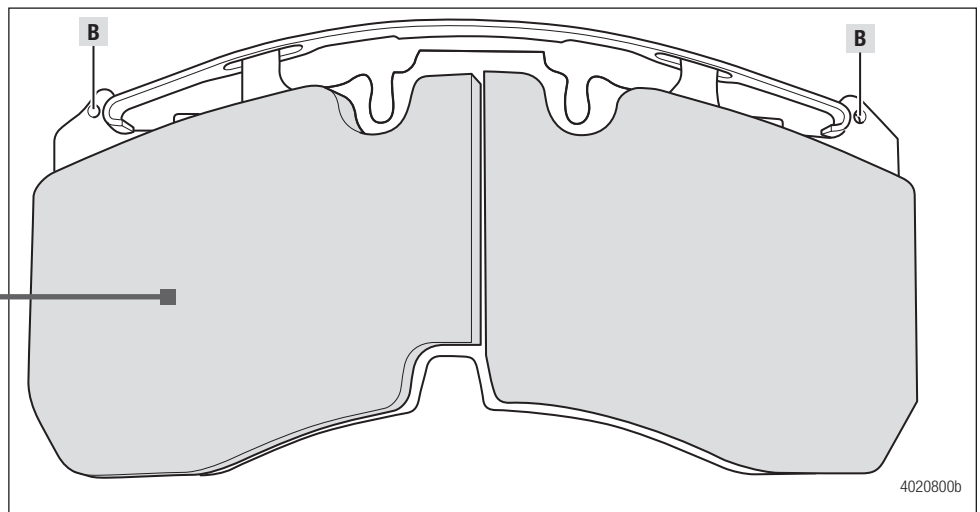

3

Insert one end of each spring [A] into each of the holes [B] in the top of the PPR pad, making sure the center bends in the springs are facing inward.

NOTE: The springs will be difficult to install if they are upside down or backwards.

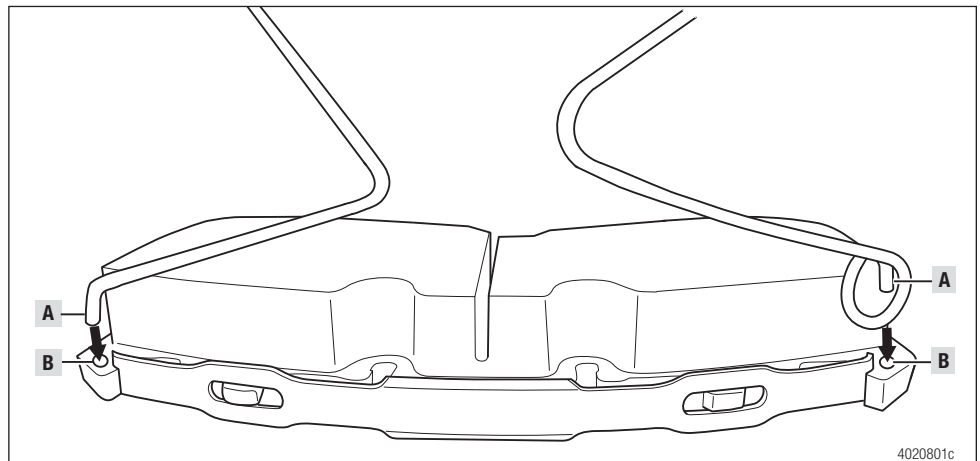

SERVICE PARTS INSTRUCTIONS

4

WARNING

Compressed springs can release unexpectedly. Use care and wear eye protection during installation to prevent injury.

Hold the second PPR pad above and insert the other ends of the springs, one at a time, into the holes on the second pad.

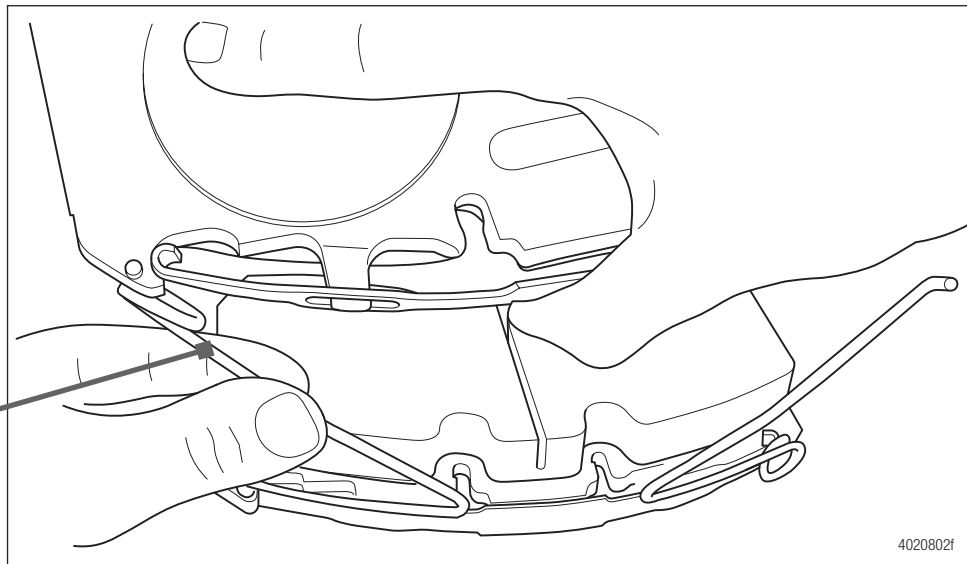

Springs correctly installed.



Ensure the ends of the springs are fully seated through the holes.

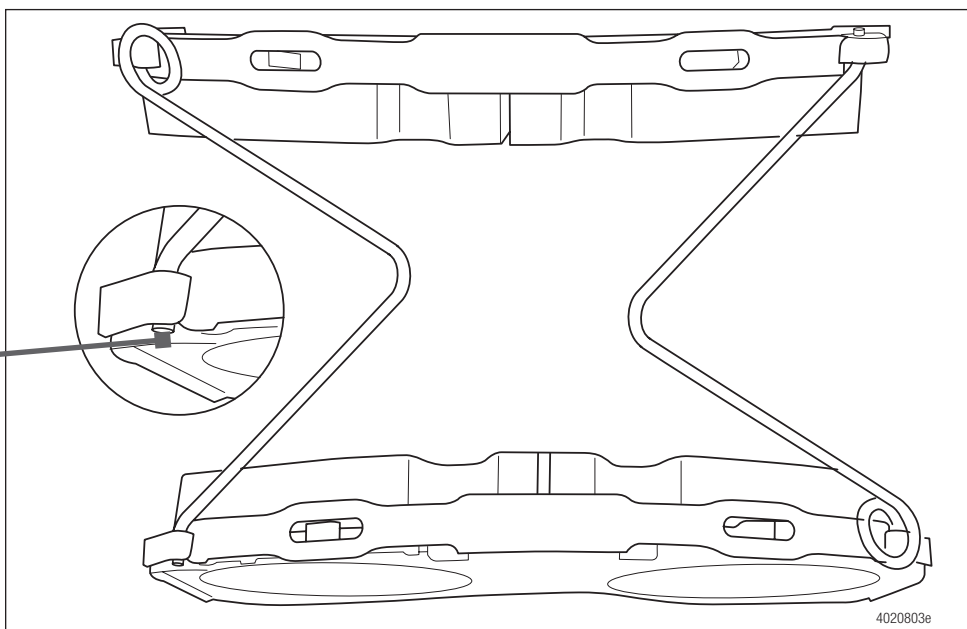

SERVICE PARTS INSTRUCTIONS

5

With the brake fully de-adjusted, install the assembled pads and springs into the caliper, over the rotor.

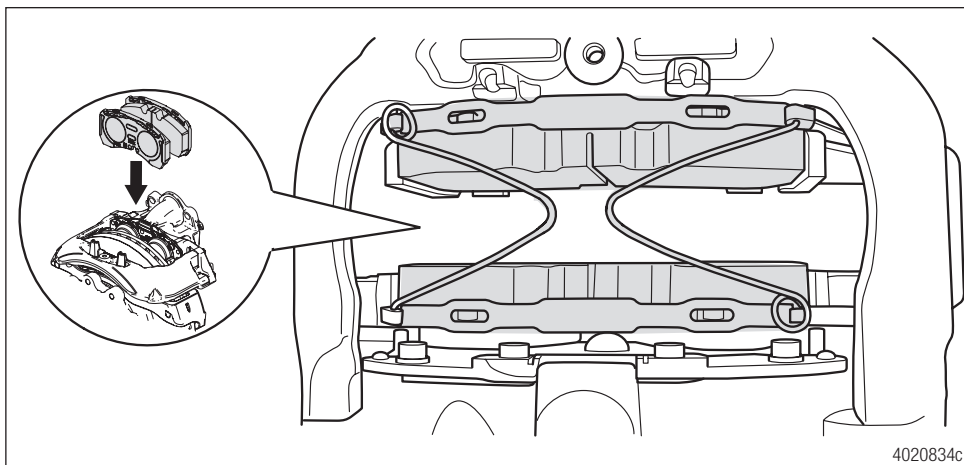

6

Install the pad strap with the center bends of the springs captured underneath.

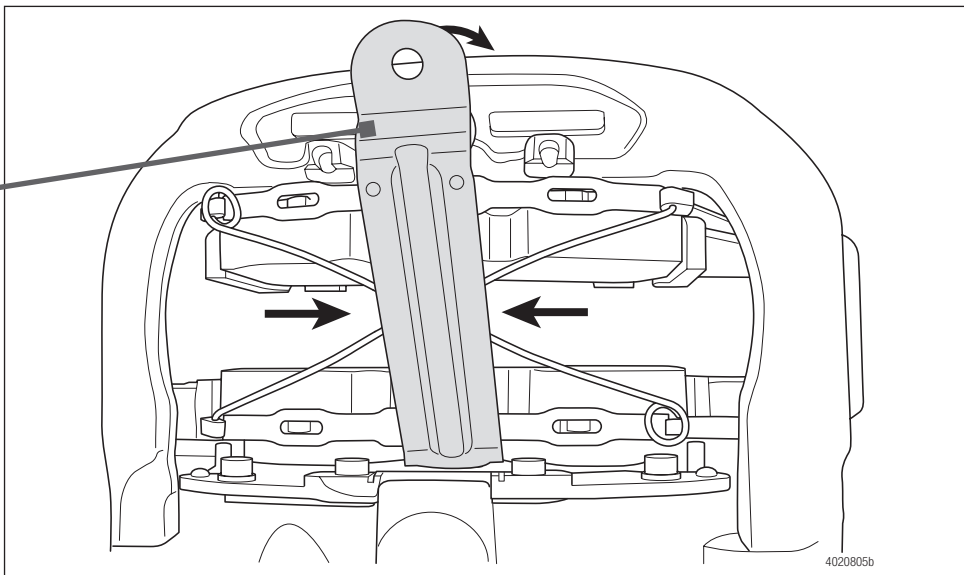

7

Install the pad strap bolt and tighten to 25-30 lb-ft (35-40 Nm).

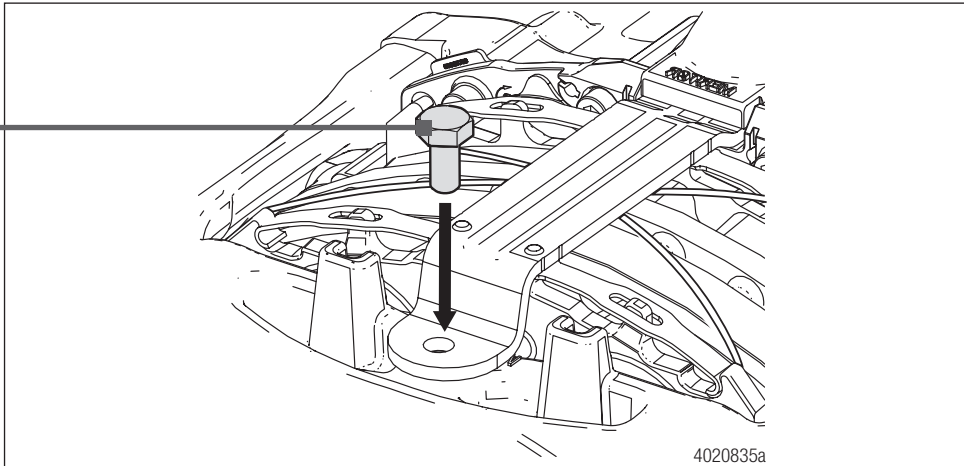

Meritor Heavy Vehicle Systems, LLC
2135 West Maple Road
Troy, MI 48064 USA
866-OnTrac1 (668-7221)
meritor.com

Information contained in this publication was in effect at the time the publication was approved for printing and is subject to change without notice or liability. Meritor Heavy Vehicle Systems, LLC, reserves the right to revise the information presented or to discontinue the production of parts described at any time.

Copyright 2024
Meritor Inc.
All Rights Reserved

Printed in USA

TP-2233
Revised 07-24
(16579)