

EUCLID® REAM KING PIN KITS



TRUST MATTERS.

Reliable Performance Across a Wide Range of Applications

The expanded line of Euclid all-makes ream king pin kits includes 65 new king pin kits with bronze and composite bushings and covers virtually every truck on the road.

Euclid king pins are built with quality and performance in mind. High-quality steel is used for high strength pins, providing exceptional support for a tight turn angle radius. The smooth surface finish helps ease steering effort for a comfortable ride.

Euclid High-Quality All-Makes Parts

For over 80 years Euclid has been a trusted brand for high-quality aftermarket parts. You can spec with confidence knowing all Euclid products meet industry standards and are backed by a 1-year warranty.

Strong Service and Support

For complete Euclid aftermarket parts information, visit

MeritorPartsXpress.com.

Or call our U.S. Customer Care Center at 888-725-9355.

In Canada, call 800-387-3889.

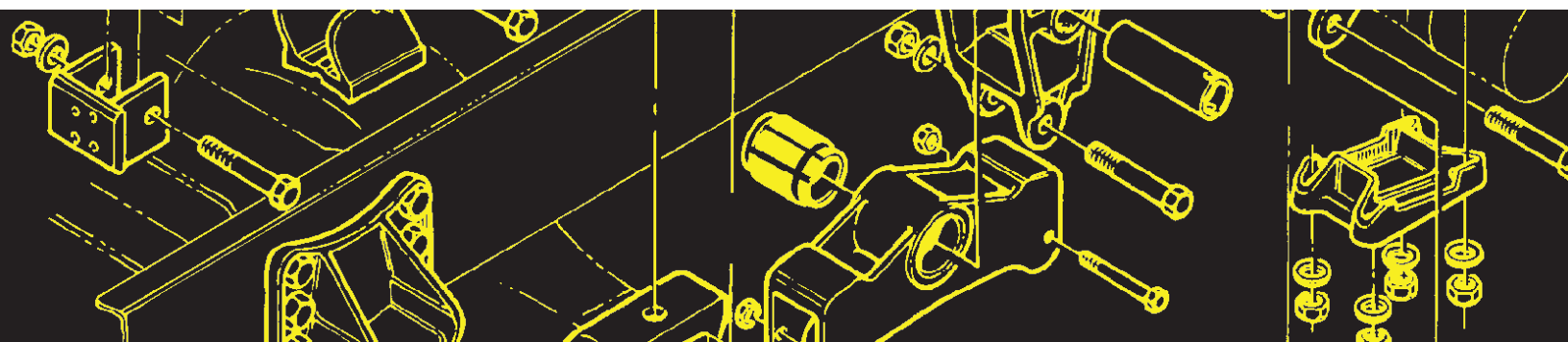

EUCLID® REAM KING PIN KITS



CROSS-REFERENCES

Euclid Ream Kit	Bushing Type	STEMCO® Kaiser ECONO KIT™	Dayton 300 Kit	Automann Kit	OEM KIT
E-17886B	Bronze	50.981.18	300-299	460.518C	
E-6198B	Bronze	50.101.09	300-268	460.244B	
E-17859B	Bronze	58.946.18	300-312	460.526C	
E-17666B	Bronze	50.103.19	300-318	460.536C	
E-17860B	Bronze	50.080.18	300-316	460.530C	
E-4467B	Bronze	50.533.13	300-231	460.194B	
E-9942B	Bronze	50.141.19	300-277	460.262B	
E-17861B	Bronze	50.070.18	300-314	460.532C	
E-17862B	Bronze	50.616.13	300-245	460.212B	
E-10105B	Bronze		300-288	460.268B	
E-10106B	Bronze		300-289	460.492B	
E-17863B	Bronze		300-342		
E-17864B	Bronze		300-340	460.542N	
E-17865B	Bronze		300-368	460.608C	
E-17866B	Bronze		300-369	460.609C	
E-17867B	Bronze				
E-17868B	Bronze		300-SRK113		
E-17885B	Bronze	57.931.18	300-264	460.208B	
E-17890B	Bronze	58.901.12	300-210	460.128B	
E-17891B	Bronze	58.931.12	300-330	460.537C	
E-17876B	Bronze	50.101.09	300-218	460.174B	
E-17888B	Bronze	50.125.23	300-234	460.201B	
E-17889B	Bronze	50.126.23	300-235	460.200B	
E-17872B	Bronze	50.160.19	300-278	460.506C	
E-17873B	Bronze	50.941.06	300-217 300-261 300-280	460.168B	
E-17879B	Bronze	50.941.18	300-324	460.325C	
E-17871B	Bronze	50.140.09	300-249	460.216B 460.148B	
E-17882B	Bronze	50.140.09	300-205	460.160B	
E-17869B	Bronze	50.056.07	300-279	460.480B	
E-17870B	Bronze	50.076.06	300-286	460.264B	
E-17874B	Bronze				
E-17875B	Bronze	50.070.04	300-140	460.116B	
E-17880B	Bronze	50.309.09	300-223		
E-17881B	Bronze	50.310.09	300-248	460.206B	
E-17884B	Bronze	50.121.07	300-233	460.196B	
E-17887B	Bronze	50.901.12	300-182	460.519B	

CROSS-REFERENCES (continued)

Euclid Ream Kit	Bushing Type	STEMCO® Kaiser ECONO KIT™	Dayton 300 Kit	Automann Kit	OEM KIT
E-11394B	Bronze	50.122.05	300-293 300-297	460.286B	
E-6199B	Bronze	50.961.12	300-284	460.246B	
E-9941B	Bronze	50.120.09	300-276	460.260B 460.260C	
E-14050B	Bronze	70.147.05	300-305	460.534B	
E-4696B	Bronze	50.120.05	300-274	460.220C 460.254B	
E-11810B	Bronze	57.931.18	300-331	460.469C	
E-12512B	Bronze	58.931.12	300-216	460.166C	
E-17668B	Bronze	50.931.12	300-232	460.204C	
E-17669B	Bronze	50.146.05	300-294 300-295 300-307	460.512C	
E-17672B	Bronze	50.180.05	300-283	460.242B	
E-17667B	Bronze	50.181.18	300-329 300-330	460.537C	
E-11813B	Bronze	50.180.19	300-310	460.528C	
E-17673B	Bronze				
E-17674B	Bronze	50.123.05	300-303 300-304	460.524B	
E-17675B	Bronze		300-350	460.538 460.538E	
E-17676B	Bronze		300-354		
E-6869B	Bronze	50.121.05	300-275	460.254B	
E-17677B	Bronze	50.120.18	300-334 300-333		
E-14051B	Bronze		300-330	460.537C	
E-13999	Composite	50.121.08	300-336		60961-040 SRK107-01
E-14000	Composite		300-336-2		60961-009
E-14001	Composite		300-336-1		60961-039
E-17644	Composite				60961-628
E-17645	Composite				60961-629
E-17646	Composite				60961-630
E-17664	Composite		300-102		R-010300
E-17665	Composite		300-101		R-003270 SRK107
E-17665	Composite				R-003270 SRK107



Cummins Inc.
Box 3005
Columbus, IN 47202-3005
U.S.A

cummins.com | MeritorPartsXpress.com