

MERITOR® GENUINE LIGHT WEIGHT TRAILER HUBS FOR THE AFTERMARKET



PROVEN PERFORMANCE

The distinguished line of Meritor Genuine light weight TP/TN trailer hubs is a leading aftermarket choice for quality and reliability backed by our industry-leading customer service and a one-year warranty. Meritor Genuine light weight trailer hubs provide reliability and proven performance for both steel and aluminum disc wheels. As an industry leader in heavy-duty aftermarket solutions, Meritor provides OE quality lightweight trailer hubs engineered and manufactured to exacting specifications.

MERITOR TP/TN HUB ADVANTAGES

- Genuine OE replacement product for original performance
- Application coverage for most popular trailer hub part numbers
- Use with industry-standard roller bearing, wheel seals, hub caps and spindled nuts
- Backed by Meritor's standard one-year warranty and complete Customer Care support
- Meritor Genuine light weight hubs in combination with Meritor seals and Temper-Loc® nut offer an extended 3-year/300,000-mile warranty

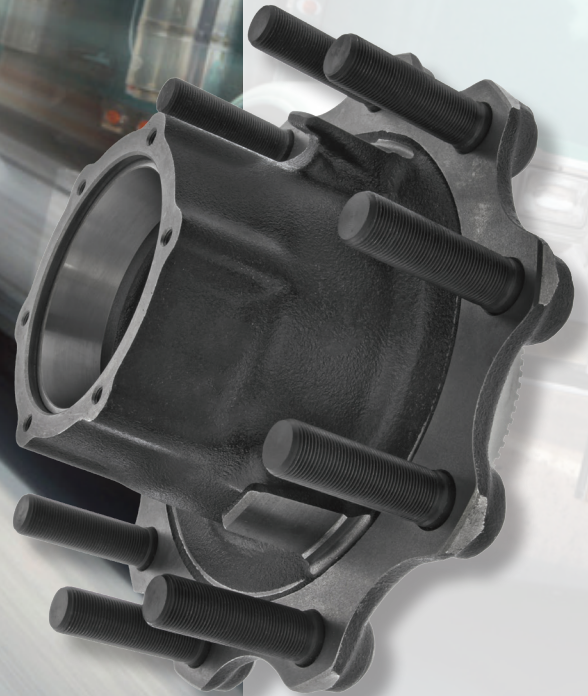

Meritor Part Number	Spindle Type	Inner Bearing Cup	Outer Bearing Cup	ABS Tone Ring	Wheel Stud PN	Wheel Stud Length	Hub Weight Only*
04-15984-021	TN	HM218210	HM212011	09001867	09002003	LONG	30 lbs
04-15984-022	TN	HM218210	HM212011	Not Included	09002003	LONG	30 lbs
04-15984-025	TN	HM218210	HM212011	09001867	09001989	SHORT	30 lbs
04-15984-026	TN	HM218210	HM212011	Not Included	09001989	SHORT	30 lbs
04-15968-043	TP	HM518410	HM518410	Not Included	09002003	LONG	34 lbs
04-15968-044	TP	HM518410	HM518410	09001867	09002003	LONG	34 lbs
04-15968-047	TP	HM518410	HM518410	09001867	09001989	SHORT	34 lbs
04-15968-052	TP	HM518410	HM518410	Not Included	09001989	SHORT	34 lbs

The following applies to all Meritor part numbers referenced above:

*Weights shown are hub only and do not include weight of the wheel studs

Wheel Mounting: 10 Stud Holes 11.25" bolt circle diameter

Hubcap Mounting: 6 Stud Holes 5.5" bolt circle diameter

Wheel Mounting Type: Hub Pilot / **Wheel Stud Size:** M22 x 1.5

Recommended Related Service Items – Bearings, Seals, and Temper-Loc® Nuts				
Axle Type	Meritor Value Bearing Set	Meritor Premium Bearing Set	Meritor Seal	Temper-Loc® Nut
TN	MERSET413 (OUTER), MERSET414 (INNER)	SET413GEN (OUTER), SET414GEN (INNER)	MER0243	MER614743
TP	MERSET415	SET415GEN	MER0223	MER614723

Recommended Related Wheel End Hardware – Wheel Studs								
Part Number	Thread Direction	Grade	Thread Size	Length	Body Diameter	Body Length	Serration Length	Thread Length
09002003	RH	10.9 (Metric)	M22 x 1.5	4.78"	.89"	.88"	.38"	3.84"
09001989	RH	10.9 (Metric)	M22 x 1.5	3.72"	.89"	.87"	.38"	2.56"



Unparalleled Service and Support.

Real peace of mind with unparalleled Customer Care. Our highly trained Customer Care team is the source for complete support. Call us at 888-725-9355 (or 800-387-3889 in Canada). Or visit MeritorPartsXpress.com for our industry-leading online catalog and ordering and tracking system with real-time access to complete part information.



Trademarks, brands, and names depicted herein are the property of Meritor, Inc. or its affiliates.



Meritor Heavy Vehicle Systems, LLC
7975 Dixie Highway
Florence, Kentucky 41042 USA

U.S.: 888-725-9355
Canada: 800-387-3889
MeritorPartsXpress.com
Meritor.com

©2019 Meritor, Inc.
Litho in USA SP-18120
Revised 8-19 (13028)