

MERITOR® MXL™ COMPONENTS AT-A-GLANCE



MERITOR



MERITOR® MXL™ COMPONENTS AT-A-GLANCE

For over a century, Meritor has been a technology leader in the design, engineering and manufacturing of driveline solutions for commercial vehicles. Meritor drivelines and components result in greater distances, lower maintenance and a greater R.O.I.

1610 Series				
U-Joint Kit	M279X	Full Round		
	M674X	Half-Round		
Product	Tubing Size (O.D. x Wall Thickness)	Spline Size		Joint Angle
Slip Yokes			Center To End Length	
16NLS32-47A2 MXL	—	2.0" - 16	10.94"	—
16NLS32-48A2 MXL	—	2.0" - 16	11.92"	—
Spline Plugs			Effective Length	
16N 40 1011	3.5" X .134"	2.0" - 16	9.69"	—
16N 40 1041	3.5" X .134"	2.0" - 16	10.19"	—
16N 40 1191	3.5" X .134"	2.0" - 16	7.56"	—
16N 40 1051	4.0" X .134"	2.0" - 16	9.84"	—
Weld Yokes			Center To Weld	
16N 28 207	3.5" X .156"	—	3.00"	30°
16N 28 627	3.5" X .134"	—	3.00"	30°
16N 28 887	3.5" X .134"	—	3.81"	—
16N 28 167	3.5" X 0.095"	—	3.00"	30°
16N 28 327	4.0" X .134"	—	3.00"	—
16NY61	4.0" X .109"	—	3.00"	19°

1710 Series				
U-Joint Kit	M280X	Full Round		
	M676X	Half-Round		
Product	Tubing Size (O.D. x Wall Thickness)	Spline Size		Joint Angle
Slip Yokes			Center To End Length	
17N 3 2401X MXL	—	2.5" - 16	12.72"	44°
17N 3 2571X MXL	—	2.5" - 16	11.72"	—
17N 3 2631X MXL	—	2.5" - 16	8.84"	—
17N 3 2651X MXL	—	2.5" - 16	11.69"	30°
17N 3 2671X MXL	—	2.5" - 16	9.59"	22°
17N 3 2761X MXL	—	2.5" - 16	6.73"	—
17N 3 3021X MXL	—	2.5" - 16	10.41"	—
17NLS40 124A1 MXL	—	2.5" - 16	11.41"	—
17NLS40 98CA1 MXL	—	2.5" - 16	7.97"	—
Spline Plugs			Effective Length	
17N 40 521	4.0" X .134"	2.5" - 16	10.56"	—
17N 40 541	4.0" X .134"	2.5" - 16	9.25"	—
Note: The 17N 40 541 spline plug should not be used with RPL. It does not have Polyglide on the splines and could compromise the sealing system used in the RPL slip yoke.				
Weld Yokes			Center To Weld	
17N 28 137	3.5" x .156"	—	3.03"	—
17N 28 347	4.0" X .134"	—	3.03"	30°
17NY60-15	4.0" X .134"	—	4.50"	42°
	4.095" X .180"	—		



1760 Series				
U-Joint Kit	M407X	Full Round		
	M677X	Half-Round		
Product	Tubing Size (O.D. x Wall Thickness)	Spline Size		Joint Angle
SLIP YOKES			CENTER TO END LENGTH	
176N 3 21X MXL	—	2.5" - 16	11.16"	30°
176N 3 41X MXL	—	2.5" - 16	9.25"	30°
SPLINE PLUGS			EFFECTIVE LENGTH	
17N 40 521	4.0" X .134"	2.5" - 16	10.56"	—
17N 40 541	4.0" X .134"	2.5" - 16	9.25"	—
WELD YOKE			CENTER TO WELD	
176N 28 17	4.0" X .134"	—	3.03"	30°

1810 Series				
U-Joint Kit	M281X	Full Round		
	M676X	Half-Round		
Product	Tubing Size (O.D. x Wall Thickness)	Spline Size		Joint Angle
Slip Yokes			Center To End Length	
18N 3 1351X MXL	—	3.00" - 16	10.25"	30°
18N 3 1371X MXL	—	3.00" - 16	11.88"	30°
Spline Plugs			Effective Length	
18N 40 191	4.50" X .134"	3.00" - 16	11.25"	—
18N 40 201	4.50" X .134"	3.00" - 16	9.47"	—
Weld Yoke			Center To Weld	
18N 28 117	4.50" X .134"	—	3.38"	30°
18N 28 127	4.50" X .259"	—	3.38"	—

Tubing	
Product	Tubing Size (O.D. x Wall Thickness)
RT 35 13 72, -108	3.5" x .095"
RT 35 10 72, -108	3.5" x .134"
RT 35 156 72, -108	3.5" x .156"
RT 4 12 72, -108	4.0" x .109"
RT 4 10 72, -108	4.0" X .134"
RT 4095 7 72, -108	4.095" X .180"
RT 45 10 72, -108	4.50" X .134"
RT 45 3 72, -108	4.50" X .259"

DRIVELINE COMPONENTS

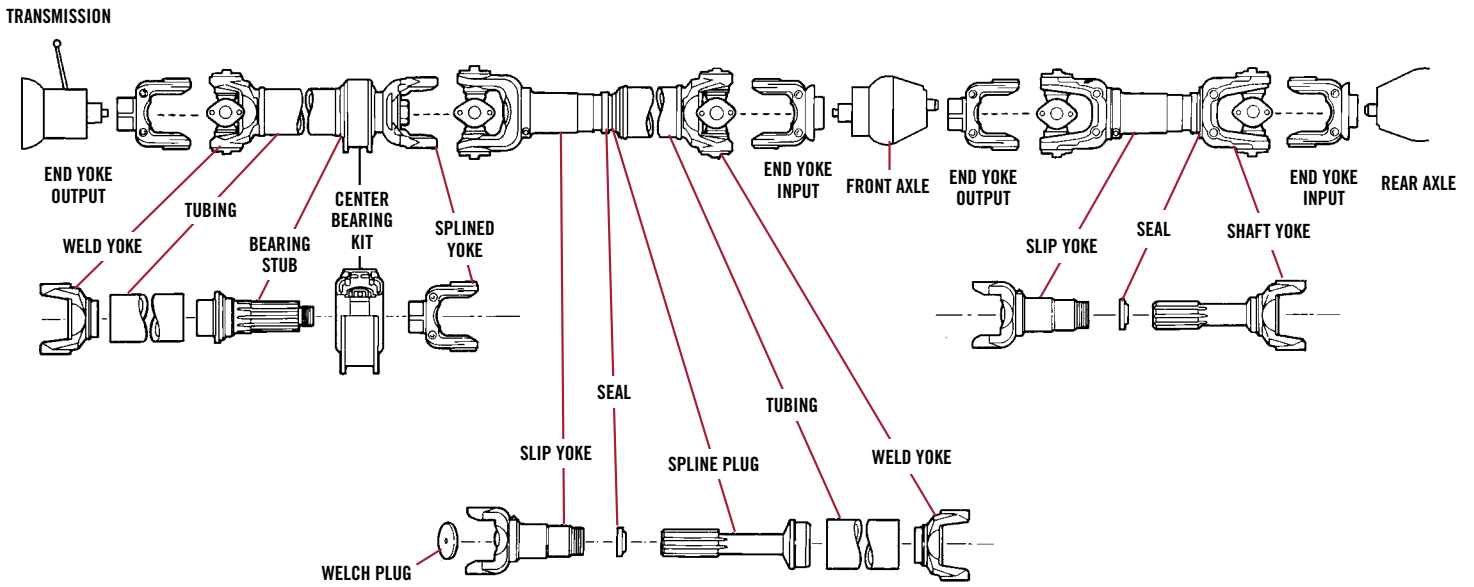

Product models, brands, names and trademarks depicted herein are the property of their respective owners and, except where otherwise indicated, are not in any way associated with Meritor Heavy Vehicle Systems, LLC, or any parent or affiliate, thereof.



Meritor Heavy Vehicle Systems, LLC
7975 Dixie Highway
Florence, Kentucky 41042 USA

888-725-9355 U.S.
800-387-3889 Canada
MeritorPartsXpress.com
meritor.com

©2017 Meritor, Inc.
Litho in USA, SP-1207
Revised 10-17 (47865/11900)