

MERITOR®

Service Parts Instructions

TP-0690
Issued 5/2006

MX-xx-120 Shim Installation Instructions

Each shim kit contains enough shims for 1 axle (four 0.005" shims – part number 2803-L-3444, four 0.015" shims – part number 2803-M-3445 and four 0.025" shims – part number 2803-N-3446).

1. Measure the vertical endplay of the knuckle
2. Use the chart below to determine the quantity of each shim that needs to be installed.
3. Install shims between the housing and the steering arm/upper cap – see diagram on reverse
4. Measure the vertical endplay of the knuckle and verify that it falls between 0.005 and 0.015 inches.

Initial Vertical Endplay (inches)	Number of Shims to Install			Final Vertical Endplay (inches)
	0.005" (2803-L-3444)	0.015" (2803-M-3445)	0.025" (2803-N-3446)	
0.000 – 0.015	-	-	-	0.000 – 0.015
0.010 – 0.020	1	-	-	0.005 – 0.015
0.015 – 0.025	2	-	-	0.005 – 0.015
0.020 – 0.030	-	1	-	0.005 – 0.015
0.025 – 0.035	1	1	-	0.005 – 0.015
0.030 – 0.040	-	-	1	0.005 – 0.015
0.035 – 0.045	1	-	1	0.005 – 0.015
0.040 – 0.050	2	-	1	0.005 – 0.015
0.045 – 0.055	-	1	1	0.005 – 0.015
0.050 – 0.060	1	1	1	0.005 – 0.015
0.055 – 0.065	-	-	2	0.005 – 0.015
0.060 – 0.070	1	-	2	0.005 – 0.015
0.065 – 0.075	2	-	2	0.005 – 0.015
0.070 – 0.080	-	1	2	0.005 – 0.015
0.075 – 0.080	1	1	2	0.005 – 0.010
0.08	2	1	2	0.005
More Than 0.080	Recheck Measurement. If still greater than 0.080" contact customer service.			

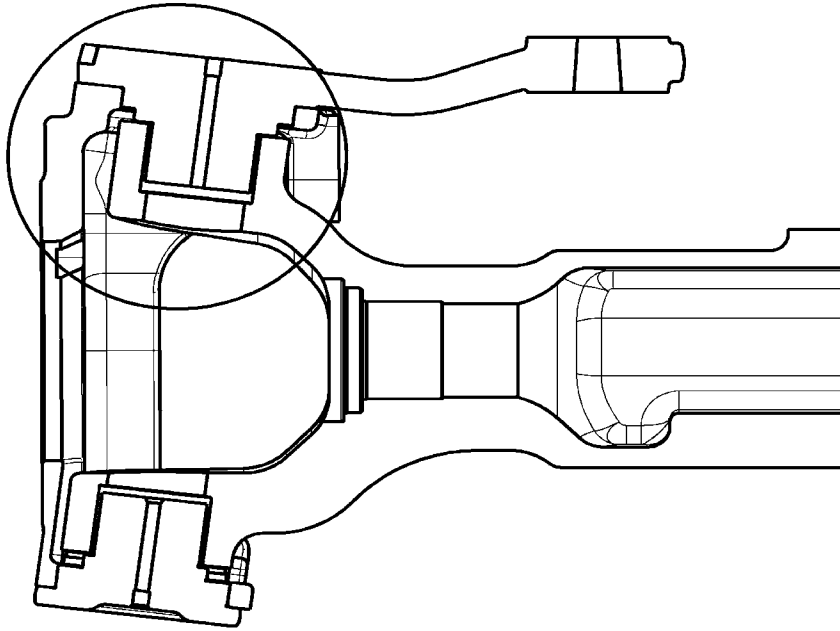

INSTALL SHIMS BETWEEN HOUSING AND STEERING ARM/UPPER CAP

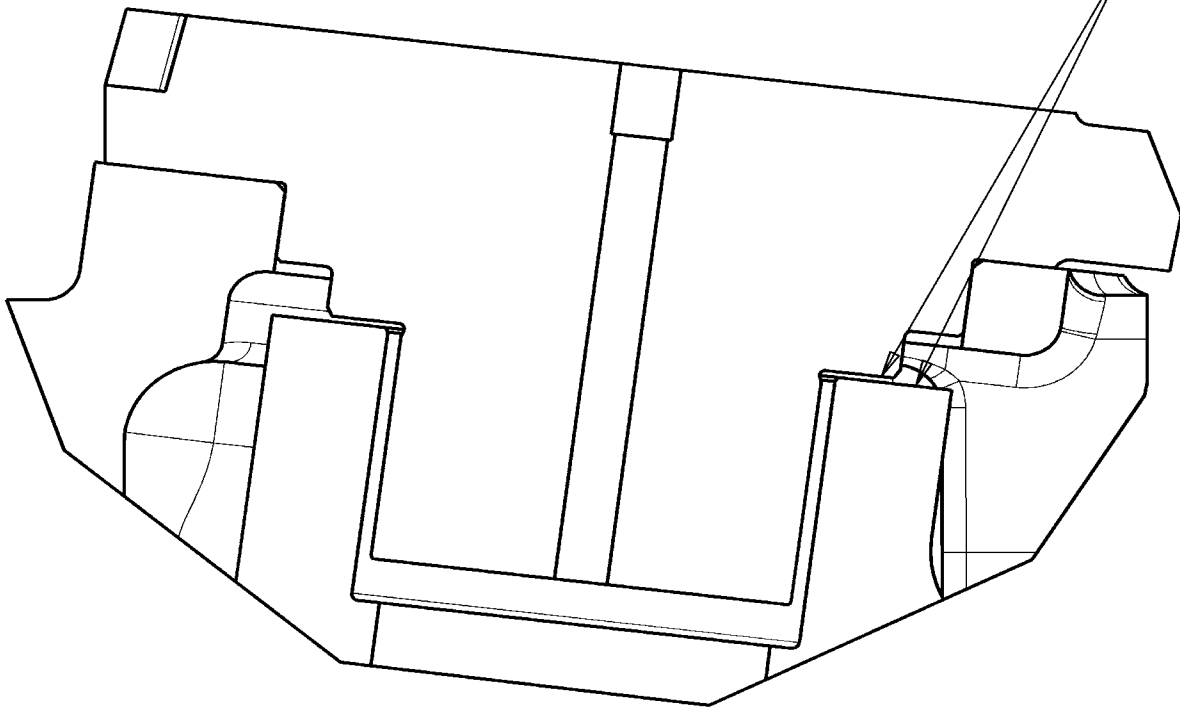

ArvinMeritor™
Commercial Vehicle Aftermarket

Meritor Heavy Vehicle Systems, LLC
7975 Dixie Highway
Florence, KY 41042 USA
888-725-9355
www.meritorhvs.com
www.xpresswayplus.com

Information contained in this publication was in effect at the time the publication was approved for printing and is subject to change without notice or liability. ArvinMeritor reserves the right to revise the information presented or discontinue the production of parts at any time.

© 2006
ArvinMeritor, Inc.

Printed in U.S.A.

Issued 5/2006
TP-0690