



**MERITOR®**

## Service Parts Instructions

## Installation and Maintenance of the Meritor® Clearance Sensing Automatic Slack Adjuster

### Use for Part Numbers:

M807009, M807010, M807011, M807012, M807016, M807017,  
M807018, M807502, M807503, M807504, M807505,  
R806009A, R806010A, R806011A, R806012A, R806016A, R806017A,  
R806018A, R806502A, R806503A, R806504A, R806505A

### How to Obtain Parts

To obtain these ASAs or ASA service kits, call Meritor's Commercial Vehicle Aftermarket at 888-725-9355 in the US or 800-387-3889 in Canada.

### ⚠ WARNING

To prevent serious eye injury, always wear safe eye protection when you perform vehicle maintenance or service.

Park the vehicle on a level surface. Block the wheels to prevent the vehicle from moving. Support the vehicle with safety stands. Do not work under a vehicle supported only by jacks. Jacks can slip and fall over. Serious personal injury and damage to components can result.

### Installation

1. Park the vehicle on a level surface. Block the wheels to prevent the vehicle from moving. Release the Parking Brake.
2. Apply the service brake several times to verify all brake chamber push rods are in their fully released position. With spring brakes, a minimum pressure of 80 psi is required in the system to ensure that the piston is fully released.

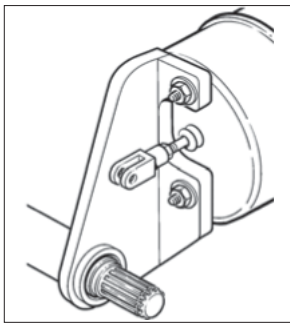

3. Loosely install U-bolt and anchor bracket saddle around camshaft tube. Do not tighten at this time.

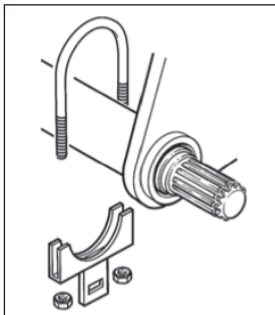

4. Coat the camshaft splines with anti-seize lubricant.

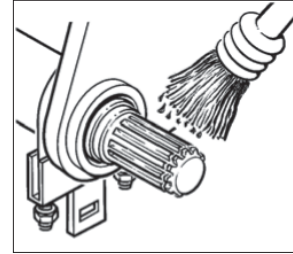

5. Fit the Automatic Slack Adjuster (ASA) onto the camshaft, so that the hex nut points away from the air chamber.

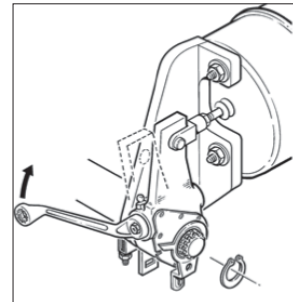

6. Wind the ASA into the clevis on the brake chamber piston rod by rotating the hex nut on the ASA in a clockwise direction until the hole in the ASA coincides with the holes in the clevis.
7. Fit the clevis pin into the clevis, thru the ASA and secure. The pin should rotate freely when no load is applied.
8. Secure the ASA on the camshaft, ensuring that it is not pinched or restricted. If the play is greater than 0.060 inch, remove snap ring and add appropriate thickness washers.
9. Rotate the control arm as far as possible, away from the hex nut C, and towards the air chamber.

The indicator A on the control arm should now be aligned with notch B in the cover plate.

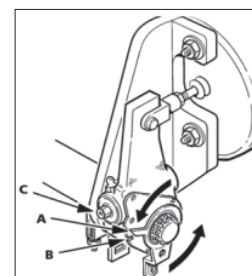

10. Install anchor stud into anchor bracket assembly and finger tighten using the 7/16" flange head nut. Position anchor stud in control arm slot. While insuring that the control arm does not move out of position, as set in step 9, tighten the U-bolt to the camshaft tube and anchor stud.

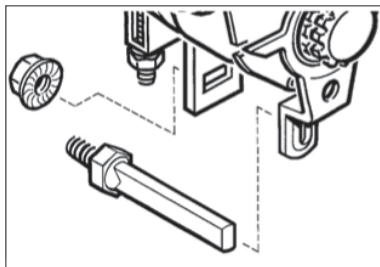

11. Adjust the clearance by rotating the hex nut on the ASA clockwise (1) until the brake lining touches the brake drum, then back-off by rotating the hex nut a 3/4 turn counterclockwise (2). Backing-off produces a loud clicking noise.

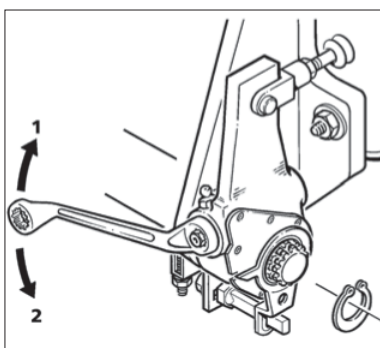

12. Check that the ASA is functioning by applying the brakes a few times. The ASA is working when the hex nut rotates clockwise on the return stroke.

**To complete the job, install the Meritor AllFit SimpleCheck™.** The Meritor SimpleCheck can be installed on standard or long-stroke air brake chambers with welded or threaded clevises. When installing SimpleCheck on a brake chamber pushrod, make certain there is enough clearance between the clevis lock nut and the brake chamber housing.

13. Install the SimpleCheck™ green disc directly onto the pushrod at the back face of the air brake chamber housing. Mounted directly onto the pushrod in that way, the green SimpleCheck disc simply moves with the pushrod when the brake is applied, providing a visual indication of whether the pushrod stroke is acceptable.

### Bolts & Washers

- 2 off 3/8" x 1-1/4" long bolt (Meritor)
- 1 off 5/16" x 1" long bolt (Fruehauf)
- 1 off 3/8" x 1-1/4" long bolt (Fruehauf)
- 2 off 1/4" x 1-1/4" long bolt (Dana)
- 2 off 1/4" flat washer (Dana)
- 1 off 1/4" x 1-1/4" long bolt (Eaton)

### Torque Settings

- |          |                 |
|----------|-----------------|
| 3/8"-16  | 20 - 25 ft.lbs. |
| 5/16"-18 | 10 - 15 ft.lbs. |
| 1/4"-20  | 5 - 7 ft.lbs.   |

## Maintenance

The ASA should be lubricated according to the lubrication maintenance schedule below.

Once a year it should be checked as follows:

With a torque wrench on the hex nut on the ASA, turn it counter-clockwise and confirm that the mechanism does not slip at a torque of less than 15 ft.lbs. Repeat the exercise three times. If the mechanism does slip at a lower torque, replace the ASA.

**No attempt should be made to repair the ASA.**

### Lubrication Maintenance Schedule

- For standard service on-highway applications we recommend to grease at 12 month intervals
- For heavy duty, off-highway or city transit applications we recommend to grease at 3 month intervals

#### **▲WARNING**

Moly (Molybdenum-Disulphide) Grease or Oil is prohibited.



Meritor Heavy Vehicle Systems, LLC  
7975 Dixie Highway  
Florence, KY 41042 USA  
888-725-9355  
meritor.com  
MeritorPartsOnline.com

Information contained in this publication was in effect at the time the publication was approved for printing and is subject to change without notice or liability. Meritor Heavy Vehicle Systems, LLC, reserves the right to revise the information presented or to discontinue the production of parts described at any time.

Copyright 2016  
Meritor, Inc.  
All Rights Reserved

TP-0546  
Revised 03-16  
Printed in USA (FLOA/16579)