

# ADVANCED 6X2 REAR AXLE SOLUTIONS

## FUELITE™/ FUELITE+™ 6X2 TANDEM AXLES

Cummins-Meritor 6x2 drive axles have become an innovative solution for fleets seeking to improve operations by saving fuel costs and increasing payload capacities. With FUELite and FUELite+, Cummins-Meritor covers a broad range of ratios and gross combination weights (GCWs) to fit many applications and meet the high demands of today's downspeed engines.

- Nearly 400 pounds in weight savings compared to a standard 6x4 tandem
- Approximately 2% more fuel efficient\* versus a standard 6x4
- Wide range of ratios (2.06 – 4.10), housing track widths and options
- 4-year/400,000-mile general service warranty

**400 LBS**  
**WEIGHT**  
**REDUCTION**

**2%**  
**GAIN**  
**IN FUEL EFFICIENCY**

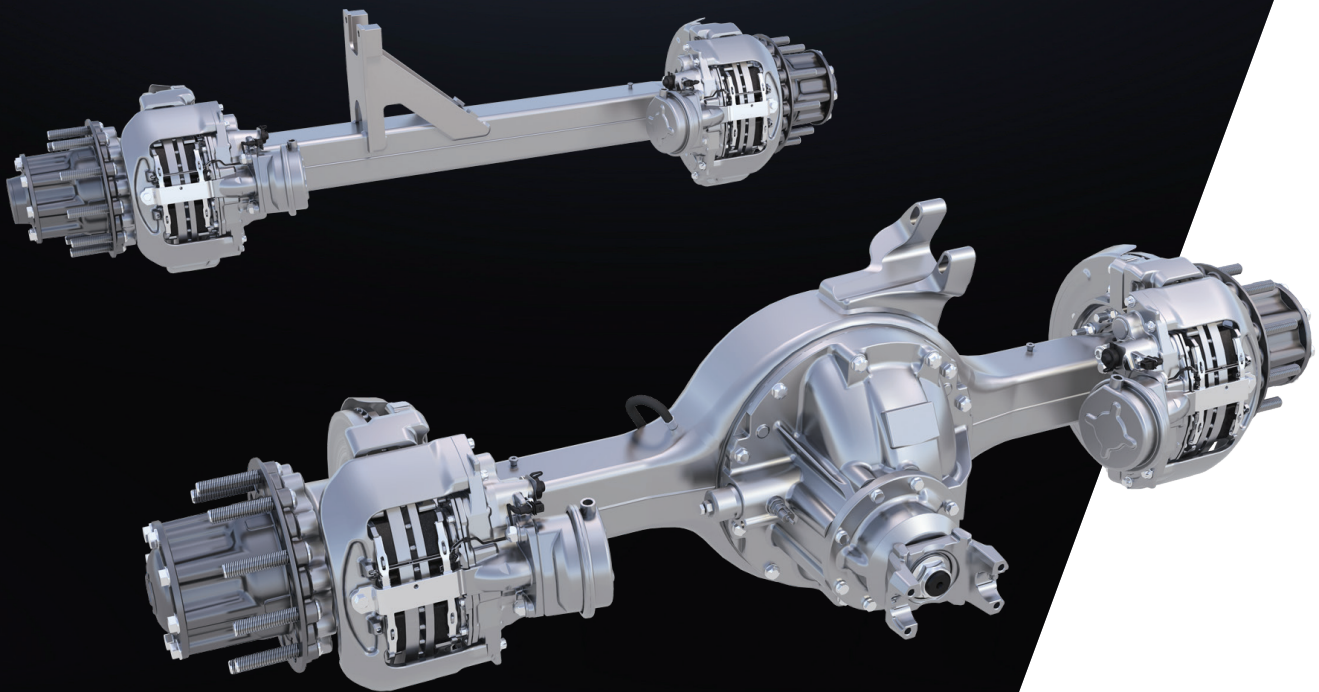

**Meritor**

**FOR  
A WORLD  
THAT'S  
ALWAYS ON™**

# LEADING THE WAY WITH ADVANCED 6X2 SOLUTIONS

In 2012, Cummins-Meritor introduced FUELite for the 6x2 market. Since then, Cummins-Meritor has been a leading provider of 6x2 solutions including the FUELite+, an even more advanced 6x2 configuration. In 2019, Cummins-Meritor released the 17X HE™, a high-efficiency version of FUELite+ with the Meritor Lube Management System (MLMS) and a high efficiency carrier.

## FEATURES AND BENEFITS

- **Lighter weight** – When compared with a standard 6x4 tandem, the FUELite series tandem axles deliver nearly 400 pounds in weight savings.
- **Fuel efficiency** – By replacing a drive axle in a traditional tandem with the FUELite tag axle, fleets can achieve significant weight savings and ~2% greater fuel efficiency.\*
- **Track width options** – Cummins-Meritor DualTrac™ allows running either wide-base single tires or duals for enhanced efficiency and improved residual value.
- **Integrated design** – Both Cummins-Meritor 6x2 configurations are engineered to deliver optimum performance with genuine Cummins-Meritor components. The design offers common wheel-ends among all axles with R-series spindles and DualTrac housing.
- **Broad application capacity** – With a wide range of ratios (2.06 – 4.10), housing track widths and options, Cummins-Meritor 6x2 axles will suit the vast majority of application needs.

## PREMIUM SUPPORT

### Axle Warranty Coverage

The Cummins-Meritor axle warranty for linehaul applications is 5 years/750,000 miles with parts and labor included. Every claim is fully supported by OnTrac™. For more information, call **1-866-668-7221 (OnTrac1)**.

### Backed by DriveForce™

FUELite, FUELite+ and 17X HE are backed by the industry's largest and best-equipped field support team. DriveForce supports Cummins-Meritor products cradle to grave and serves the North American market with a combination of sales, service and aftermarket representatives. For more information or to find your DriveForce representative, call **866-668-7221 (OnTrac1)** or visit **cummins.com**.

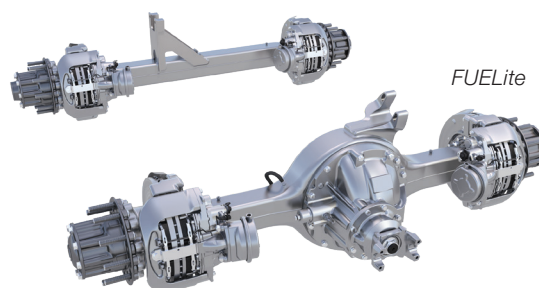

FUELite

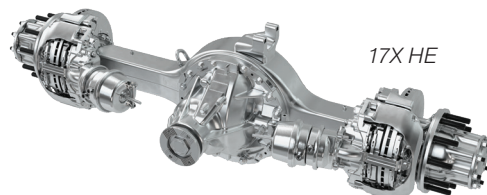

17X HE

Specifications	FUELite	FUELite+
Drive axle carrier	160 Series	17X HE
Gross axle weight rating (GAWR)	40,000 lbs	40,000 lbs
Gross combined vehicle weight rating (GCWR)	90,000 lbs	140,000 lbs
Ratio range	2.5 – 4.1	2.06 – 3.36
Weight savings vs. standard 6x4	375 lbs	395 lbs
Efficiency gains vs. standard 6x4	~2%*	~2.5-3%**
Housing	DualTrac	DualTrac
Housing wall thickness	12.7 mm	12.7 mm
Differential lock	DCDL	DCDL

\* The fuel savings described throughout this insert are estimates only. Actual fuel savings may vary and will depend on a variety of factors beyond Cummins-Meritor's control, including load, vehicle type, driver performance, distance traveled, vehicle speed, road conditions, etc.

\*\* Overall vehicle efficiency gain from axle efficiency and 2.31 ratio vs. 2.5



Cummins Inc.  
Box 3005  
Columbus, IN 47202-3005  
U.S.A.

cummins.com

SP-1578  
Bulletin 6491685 Produced in U.S.A. Rev. 8/23  
©2023 Meritor, Inc.